

7512 Series Flood Lamps

- ECE/ADR Approved for 1/00 Reverse
- Tolerant to Acidic/Alkaline Condition
- High brightness 4x3 watt LEDs
- IP67 Sea Spray/Salt Water Resistant
- Stainless Steel Fittings
- Voltage Range 9-30 Volt
- 5 Year Warranty

Function	12 Watt Flood Lamp ECE/ADR Approved 1/00 Reverse
Size	75mm x 75mm x 30mm
Voltage	9-30 Volt
LED Qty	4 x 3 watt
Lumen	Effective 489lm, Raw 660lm
Cable	40cm cable
Draw	
@13.8V	0.59A
@28V	0.27A
Lens	Polycarbonate
Base	E-Coated Die Cast Alloy

Approvals	Function	Approval No.
CTA	Reverse 1/00	CTA-060165



Reverse/Flood Lamp, Black E-Coated
7512BM - Blister



Reverse/Flood Lamp, White E-Coated
7512WM - Blister

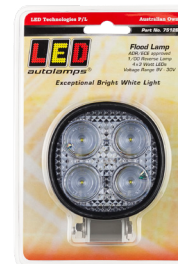
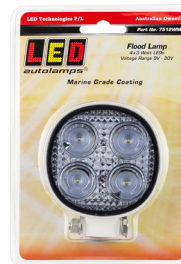
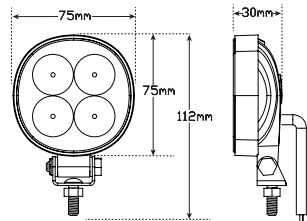
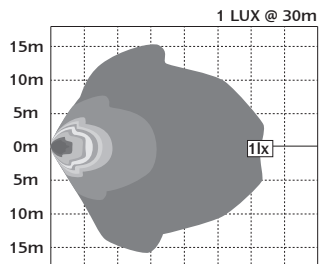

Fitting Instructions

Fix to mounting surface using stainless steel bolts and adjustable stainless steel bracket supplied.



All enquiries P: (03) 9466 7075 E: led@ledtech.com.au, www.ledautolamps.com

All efforts are made to ensure all information is correct and up to date, it can be subject to change without notice. All measurements are in millimeters (mm) and are not to scale.

© All LED Technologies designs are registered throughout the world. - Current as of 22/09/2020

ECE
Approved

100%
Water Proof

5 Year
Warranty