

# Installation and Maintenance Manual

## PUMP FOR HYDRAULIC STEERING SYSTEMS



UP25 F-SVS

UP28 F-SVS

UP33 F-SVS

UP39 F-SVS

UP25 T-SVS

UP28 T-SVS

UP33 T-SVS

UP39 T-SVS

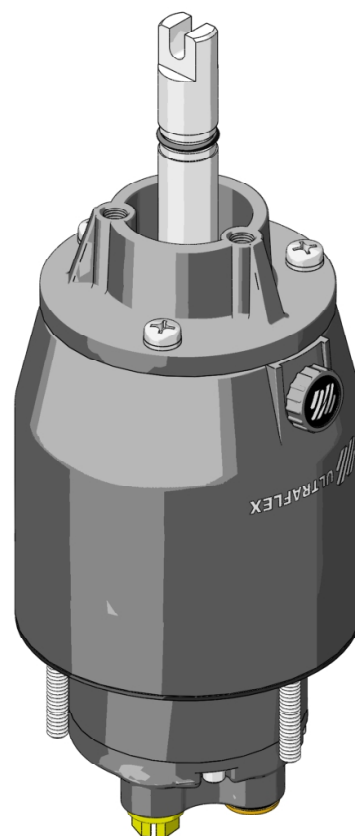

# ULTRA FLEX



PARTNER



Member of CISQ Federation  
**RINA**  
ISO 9001:2000  
Certified Quality System



Member of CISQ Federation  
**RINA**  
ISO 14001  
Certified Environmental System



Dear Customer,

We would like to thank you for choosing an **ULTRAFLEX** SpA product.

**ULTRAFLEX** SpA has been a leader in steering systems for pleasure and professional boats for many years.

All **ULTRAFLEX** SpA products are designed and manufactured to ensure the best performance. To ensure your safety and to maintain a high quality level, **ULTRAFLEX** SpA products are guaranteed only if they are used with original spare parts (see attached document "Application Spare Parts").

**ULTRAFLEX** SpA and Quality Management System is certified CISQ-IQNet by the Italian Shipping Registry (RINA), in conformity with the UNI EN ISO 9001:2008 rule. **ULTRAFLEX** SpA certification No. 6669/02/S (former 420/96).

The quality management system involves all the company resources and processes starting from the design, in order to:

- ensure product quality to the customer;
- maintain and improve the quality standards constantly;
- pursue a continuous process improvement to meet the market needs and to increase the customer satisfaction;
- constantly test the products to verify their conformity with the 2013/53/EU.



"Established in 1989 **UFLEX** USA is a leader in steering and control systems for the marine industry. With full manufacturing capabilities in Sarasota, Florida, **UFLEX** USA can support all sectors of the marine industry regardless of volume and/or product requirements. And, as an affiliate of the **ULTRAFLEX** Group, **UFLEX** USA has tremendous resources to draw upon for new product development in hydraulics, electronics and many other technologies.

Innovative product design and unparalleled dedication to quality customer service and products continue to be cornerstone of **UFLEX** USA's growth. Today our products can be found as originally installed equipment on many of the most widely known and respected boat brands in the world. Aftermarket parts can be sourced from trained and experienced distributor network throughout North and South America.

Our dedication to providing the highest quality products and service is only matched by our commitment to developing new products employing the latest materials and technology to enhance our customer's boating experience. From steering wheels to sophisticated electronic controls, **UFLEX** USA has everything you need to make sure that your boat looks and perform it's best for many, many years."

**UFLEX USA**

Sarasota, FL 34243 - 6442 Parkland Drive

# TABLE OF CONTENTS

DOCUMENT REVISIONS.....	4
MANUAL USE AND SYMBOLS USED.....	5
INTRODUCTION.....	6
WARRANTY.....	6

## SECTION 1 - PRODUCT DESCRIPTION

1.1 HYDRAULIC STEERING SYSTEM OPERATION .....	8
1.2 WARNINGS FOR THE CORRECT PRODUCT USE .....	8
1.3 SYSTEM CONFIGURATIONS .....	8
1.4 PUMP DESCRIPTION .....	9
1.5 PUMP TECHNICAL FEATURES .....	10

## SECTION 2 - TRANSPORT

2.1 GENERAL WARNINGS .....	12
2.2 PACKAGING CONTENTS .....	12

## SECTION 3 - INSTALLATION

3.1 NECESSARY TOOLS TO INSTALL PUMPS UP25 F-SVS - UP28 F-SVS - UP33 F-SVS - UP39 F-SVS .....	14
3.2 PUMP UP25 F-SVS - UP28 F-SVS - UP33 F-SVS - UP39 F-SVS INSTALLATION .....	14
3.3 NECESSARY TOOLS TO INSTALL PUMPS UP25 T-SVS - UP28 T-SVS - UP33 T-SVS - UP39 T-SVS .....	17
3.4 PUMP UP25 T-SVS - UP28 T-SVS - UP33 T-SVS - UP39 T-SVS INSTALLATION .....	17
3.5 TYPES OF INSTALLATION .....	20
3.6 HOSE CONNECTION TO THE SYSTEM .....	20
3.7 FILLING AND PURGING .....	21
3.7.1 POSITIONING OF THE OIL BOTTLE .....	22
3.7.2 PURGING PROCEDURE.....	22
3.8 GENERAL RECOMMENDATION .....	22

## SECTION 4 - SAFETY WARNINGS

4.1 SAFETY WARNINGS DURING USE AND INSTALLATION .....	23
4.2 CLOTHING .....	23

## SECTION 5 - MAINTENANCE

5.1 ORDINARY MAINTENANCE .....	24
5.2 STEERING WHEEL DISASSEMBLY .....	24
5.3 TROUBLESHOOTING .....	24

## SECTION 6 - DISMANTLING

6.1 DISMANTLING .....	26
-----------------------	----

---

**DOCUMENT REVISIONS**



---

Rev.	Date	Revision description
0	31/10/2008	First edition
1	08/03/2013	Addition of models 39 F-SVS 28-33-39 F-SVS and change to swiveling fittings
2	16/07/2014	Change to chapters "Packaging contents" and "Oil bottle positioning" . addition of model 25 F-SVS and 25 T-SVS
3	15/12/2014	Change of oil specifications

## MANUAL USE AND SYMBOLS USED

THE INSTALLATION AND MAINTENANCE MANUAL is the document accompanying the product from its sale to its replacement and discharge. The manual is an important part of the product itself. It is necessary to read carefully the manual, before ANY ACTIVITY involving the product, handling and unloading included.

In this manual the following symbols are used to ensure the user safety and to guarantee the correct operation of the product:

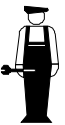
- 
DANGER
➔
Immediate hazards which CAUSE severe personal injury or death.
- 
WARNING
➔
Denotes that a hazard exists which can result in injury or death if proper precautions are not taken.
- 
CAUTION
➔
Denotes a reminder of safety practices or directs attention to unsafe practices which could result in personal injury or damage to the craft or components or to the environment.
- NOTICE
➔
Important information for the correct installation and for maintenance, that does not cause any damage.
- 
➔
The symbol aside indicates all the operations which must be carried out by qualified or skilled staff, in order to avoid hazards. We recommend training the staff in charge of the product installation and checking their knowledge.

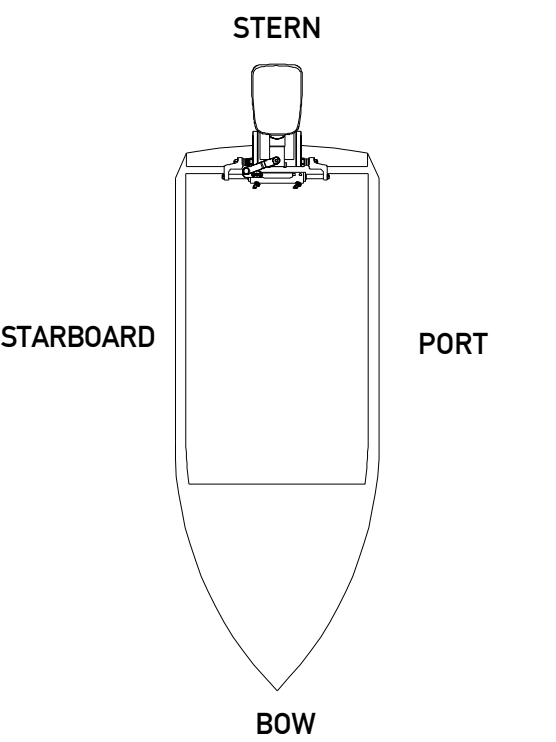

**STERN**

**BOW**

**STARBOARD**

**PORT**

➔

The picture aside explains the meaning of some nautical words contained in this manual.

**LEGEND**

m.p.h. = miles per hour  
 km/h = kilometres per hour

10 m.p.h. = 8,69 knots  
 10 m.p.h. = 16,1 km/h  
 10 knots = 11,5 m.p.h.  
 10 knots = 18,5 km/h  
 10 km/h = 6,21 m.p.h.  
 10 km/h = 5,4 knots



## INTRODUCTION

This installation and maintenance manual represents an important part of the product and must be available to the people in charge of its use and maintenance.

The user must know the content of this manual.

**UFLEX** declines all responsibility for possible mistakes in this manual due to printing errors.

Apart from the essential features of the described product, **UFLEX** reserves the right to make those modifications, such as descriptions, details and illustrations, that are considered to be suitable for its improvement, or for design or sales requirements, at any moment and without being obliged to update this publication.

ALL RIGHTS ARE RESERVED. Publishing rights, trademarks, part numbers and photographs of **UFLEX** products contained in this manual are **UFLEX** property.

Great care has been taken in collecting and checking the documentation contained in this manual to make it as complete and comprehensible as possible. Nothing contained in this manual can be interpreted as warranty either expressed or implied - including, not in a restricted way, the suitability warranty for any special purpose. Nothing contained in this manual can be interpreted as a modification or confirmation of the terms of any purchase contract.

### **⚠ WARNING**

To ensure the correct product and component operation, the product must be installed by qualified staff. In case of part damage or malfunction, please contact the qualified staff or our Technical Assistance Service.

#### TECHNICAL ASSISTANCE SERVICE

##### North - South - Central America:

##### **UFLEX USA**

6442 Parkland Drive

Sarasota, FL 34243

Ph.: +1.941.351.2628

Fax: +1.941.360.9171

Email: [uflex@uflexusa.com](mailto:uflex@uflexusa.com)

[www.uflexusa.com](http://www.uflexusa.com)

##### **UFLEX S.r.l.**

Via Milite Ignoto,8A

16012 Busalla (GE)-Italy

Ph.: +39.010.962.01

Fax: +39.010.962.0333

Email: [ut@uflexgroup.it](mailto:ut@uflexgroup.it)

[www.uflexgroup.it](http://www.uflexgroup.it)

## WARRANTY

1. **Two Year Limited Warranty.** **UFLEX USA, Inc.** warrants that all products manufactured by **UFLEX USA, Inc.** or **ULTRAFLEX S.p.A.** and sold by **UFLEX USA** to the retail purchaser ("Purchaser") that for two (2) years after the date of manufacture to be free from defects due to material or workmanship, subject to the exclusions below. Improper installation **AVOIDS** this warranty. Installation should only be attempted by a trained and qualified technician.
2. **Exclusions.** This limited warranty does not cover and does not extend to any of the following:
  - (a) Failure caused by normal wear and tear, climatic conditions, misuse, neglect, lack of proper maintenance, accident, fire or other casualty damage, racing, overloading, negligence, modification, beaching or grounding of vessel, collision, impact, towing, acts of war or hostilities;
  - (b) components not manufactured by **UFLEX USA, Inc.**, or its affiliates;
  - (c) cost of removal or reinstallation of any component (including components manufactured by **UFLEX USA, Inc.**) or disassembly or reassembly of the unit containing the component;
  - (d) components not manufactured by **UFLEX USA, Inc.** or **ULTRAFLEX S.p.A.**, whether or not warranted by the other manufacturer;
  - (e) any product which has not been properly installed.



3. **Limitations.** THE REPAIR OR REPLACEMENT OF DEFECTIVE PARTS SHALL BE PURCHASER'S SOLE AND EXCLUSIVE REMEDY AND **UFLEX USA, INC.'S** SOLE AND EXCLUSIVE LIABILITY UNDER THIS WARRANTY. LABOR FOR REPLACEMENT IS NOT INCLUDED. **UFLEX USA, Inc.'s** obligation under this warranty is limited to the repair or replacement (at **UFLEX USA, Inc.'s** sole election) of any covered item found to be defective, when delivered by Purchaser pursuant to written authorization and instructions from **UFLEX USA, Inc.**, shipping prepaid to **UFLEX USA, Inc.'s** plant or other designated repair facility. Repaired or replaced items are warranted as provided herein for the unexpired portion of the applicable warranty period. THIS WARRANTY, AND THE RIGHTS AND REMEDIES UNDER IT, IS EXCLUSIVE AND IS GIVEN IN PLACE OF ALL OTHER WARRANTIES, WHETHER EXPRESS OR IMPLIED, INCLUDING ANY IMPLIED WARRANTY OF MERCHANTABILITY OR FITNESS FOR PARTICULAR PURPOSE, WHETHER ARISING BY LAW, CUSTOM, CONDUCT OR USAGE OF TRADE, PURCHASER'S REMEDIES SHALL BE LIMITED AS STATED HEREIN AND **UFLEX USA, INC.** SHALL NOT BE LIABLE FOR ANY INCIDENTAL, CONSEQUENTIAL OR INDIRECT DAMAGES OR LOSSES RESULTING FROM DEFECTS. THE RETAIL SELLER IS NOT A CO-WARRANTOR AND IS NOT AUTHORIZED BY **UFLEX USA, INC.** TO AMEND OR MODIFY THIS LIMITED WARRANTY IN ANY MANNER.
4. **Transferability of Warranty.** This limited warranty may not be transferred to subsequent purchasers.
5. **Miscellaneous.** **UFLEX USA, Inc.** is an affiliate of **ULTRAFLEX S.p.A.** **UFLEX, USA, Inc.**, reserves the right to make changes in the design and construction of its products at any time, without notice and without any obligation to incorporate such changes into products of prior manufacture. This limited warranty applies to new components sold by **UFLEX USA, Inc.**. This limited warranty contains the entire agreements between **UFLEX USA, Inc.** and Purchaser and supersedes all prior agreements, discussions, negotiations, commitments and representations, whether oral or written, between them regarding **UFLEX USA, Inc.'s** warranty. If any provision of this limited warranty, or the application of it, is determined to be invalid or unenforceable for any reason, the remainder of this limited warranty and the application of it shall not be affected.
6. **Ultron 3000 and PowerC.** The Ultron 3000 and "PowerC - User and Installation Manual" describes activities, operations, technical specifications which must be followed during the installation and/or usage of the product, in order to keep a valid warranty. Descriptions and drawings in that manual are suitable to allow installation and use of the product to skilled persons. In case of doubt and/or for any information, please contact our Technical Service.

All communications and notices from Purchaser regarding this limited warranty should be sent to: **UFLEX USA, INC.**, 6442 Parkland Drive, Sarasota, FL 34243; (941) 351-2628.

## Return policy

Any product that is presumed defective should be reported to **UFLEX USA** within 48 hours of receipt or discovery in the field. Upon notification **UFLEX USA** will attempt to troubleshoot the problem with our customer over the phone. If we are unable to resolve the problem **UFLEX** will issue a Return Goods Authorization number and we require that the product in question be returned to **UFLEX** with all its parts in its original packaging. The product should be returned freight prepaid to:

**UFLEX USA**  
RGA Department - RGA #  
6442 Parkland Drive  
Sarasota, Florida 34243

Upon receipt **UFLEX** will examine the product to determine the cause of the defect. If the product is determined to have a defect in workmanship or material, it will be repaired at our discretion.

Our warranty does not cover labor, towing or other expenses. Further, it does not cover products that have been improperly installed, damaged in installation, misapplied, or misused.

Our products are not intended for use in racing applications.



# 1 PRODUCT DESCRIPTION

## 1.1 Hydraulic steering system operation

All **UFLEX** hydraulic steering systems are designed in conformity with UNI-EN-ISO 10592 and A.B.Y.C. P21 regulations. All **UFLEX** steering systems can operate at temperatures between -18°C (0°F) and +77°C (+170°F). All the components are made for the marine environment, using materials and working processes which offer long life and safety under the most extreme conditions. A hydraulic steering system consists of a steering pump, a cylinder tied to the rudder or to the outboard or sterndrive engine and the connecting hoses (see picture). Under normal operating conditions, a turn of the steering wheel will pump the oil, which flows in through the hoses to the cylinder, according to the turn direction. With the consequent cylinder movement the oil will flow to the pump through the hoses and at the same time moves the engine or the helm which are connected to the cylinder. The pumps UP25 F-SVS, UP28 F-SVS, UP33 F-SVS, UP39 F-SVS, UP25 T-SVS, UP28 T-SVS, UP33 T-SVS and UP39 T-SVS are equipped with a pressure relief valve, which prevents outgoing fluid from returning along the same hose. It also allows the operation of the steering systems with two or more steering stations. The unbalanced cylinders cannot be used with the pumps UP25 F-SVS, UP28 F-SVS, UP33 F-SVS, UP39 F-SVS, UP25 T-SVS, UP28 T-SVS, UP33 T-SVS and UP39 T-SVS. A well balanced steering system needs a correct choice of the pump for the cylinder. **UFLEX** produces different pump models, which have different capacity (cm<sup>3</sup> of oil moved each steering wheel turn) and for each type of installation. While choosing the pump it is important to consider the cylinder volume. The number of starboard and port turns is determined by the ratio between the cylinder volume and the pump capacity. The release pressure of the pressure relief valves is of 10,3MPa (105 bar) (1500 PSI).

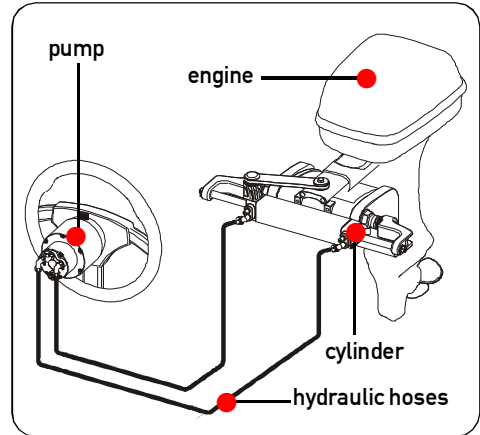

**Example:** if the pump has a capacity of 28 cm<sup>3</sup> [1.7cu.in.] and the cylinder has a volume of 120 cm<sup>3</sup> [7.3cu.in.], the formula looks like this: 120/28=4.2. Accordingly, the steering wheel will turn about 4 times before the cylinder will completely turn from one side to the other. In case of installations with double cylinders connected in parallel the cylinder volume must be added. Applications with less than 4 turns are not recommended, as they need a higher effort, also applications with more than 8 turns are not recommended, as the response of the boat to steer is slowly.

## 1.2 Warnings for the correct product use

**⚠ DANGER**

Do not modify the steering cylinder in any way to fit it to your application, otherwise the cylinder will no longer operate in safety and it will endanger the boat and the occupants.

**⚠ WARNING**

All **UFLEX** steering systems must not be installed on boats equipped with engines whose maximum horsepower is higher than the horsepower rating approved by boat manufacturer.

**⚠ WARNING**

**UFLEX** steering systems must not be installed on race boats.

**⚠ WARNING**

The pumps UP25 F-SVS, UP28 F-SVS, UP33 F-SVS, UP39 F-SVS, UP25 T-SVS, UP28 T-SVS, UP33 T-SVS and UP39 T-SVS cannot be used with unbalanced cylinders.

## 1.3 System configurations

**⚠ WARNING**

The pumps UP25 F-SVS, UP28 F-SVS, UP33 F-SVS, UP39 F-SVS, UP25 T-SVS, UP28 T-SVS, UP33 T-SVS and UP39 T-SVS can only be used with SVS hydraulic cylinders and hoses (outboard cylinder UC128-SVS and Kit OB-SVS)

**⚠ CAUTION**

Always connect the hoses correctly as indicated in the installation and maintenance manuals of the corresponding hydraulic cylinders.





### 1.4 Pump description

The pumps UP25 F-SVS, UP28 F-SVS, UP33 F-SVS and UP39 F-SVS have been designed and manufactured to be used as a component in the hydraulic steering systems, as described in the previous paragraph. The pumps UP25 F-SVS, UP28 F-SVS, UP33 F-SVS and UP39 F-SVS must be installed on the front part of the boat dashboard or semi-built-in through flange X64 or X57.

The pumps UP25 T-SVS, UP28 T-SVS, UP33 T-SVS and UP39 T-SVS must be assembled by means of tilt X70 (supplied separately).

The following pictures show the main pump components:

- 1** Pump UP25 F-SVS or UP28 F-SVS or UP33 F-SVS or UP39 F-SVS
- 2** Vent filler plug
- 3** Steering wheel connection shaft
- 4** Connections to the cylinder/s
- 5** Connections to the additional stations
- 6** M6 dowels for fixing the pump to the dashboard
- 7** Pump UP25 T-SVS or UP28 T-SVS or UP33 T-SVS or UP39 T-SVS
- 8** Connection shaft to tilt X70

#### UP25 F-SVS or UP28 F-SVS or UP33 F-SVS or UP39 F-SVS

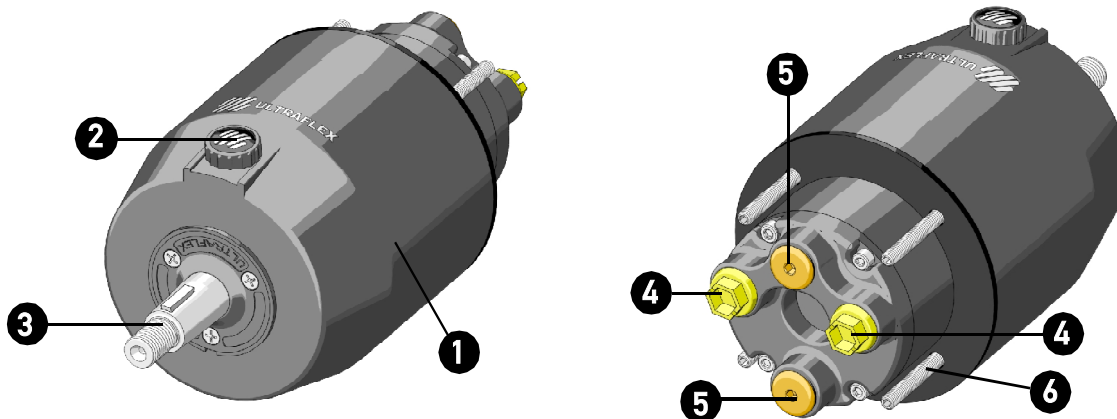

#### UP25 T-SVS or UP28 T-SVS or UP33 T-SVS or UP39 T-SVS

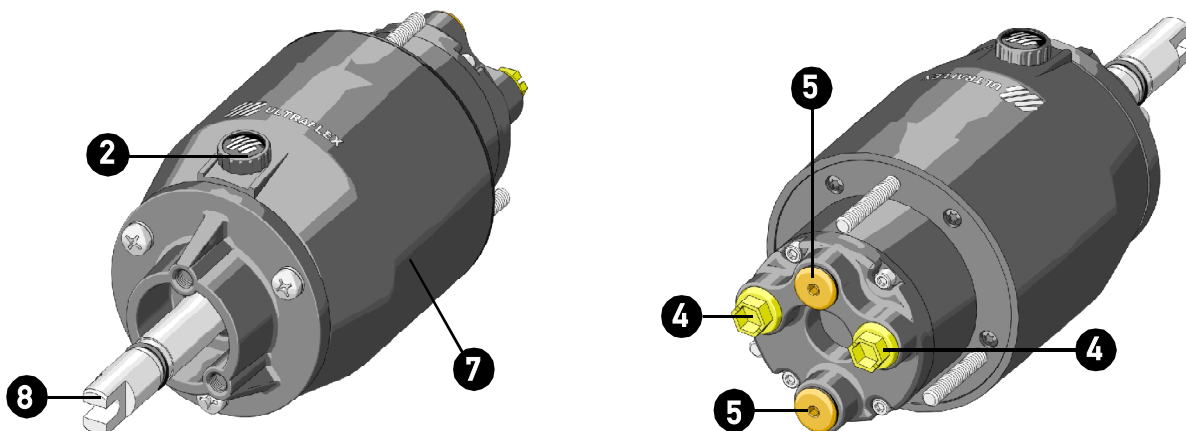

**1.5 Pump technical features**

ENGLISH

SPECIFICATIONS	PUMP UP25 F-SVS	PUMP UP28 F-SVS	PUMP UP33 F-SVS	PUMP UP39 F-SVS
Capacity	25 cc/rev. - 1,7 cu.in/rev.	28 cc/rev. - 1,7 cu.in/rev.	33 cc/rev. - 2,0 cu.in/rev.	39 cc/rev. - 2,0 cu.in/rev.
Pressure relief valve release pressure	105 bar (1500 psi)	105 bar (1500 psi)	105 bar (1500 psi)	105 bar (1500 psi)
No. of pistons	5	5	7	7
Max. steering wheel diameter	710 mm (28 in.)	710 mm (28 in.)	710 mm (28 in.)	710 mm (28 in.)
Max. steering wheel height	152 mm (6 in.)	152 mm (6 in.)	152 mm (6 in.)	152 mm (6 in.)
Weight	5 kg (11 lbs)	5 kg (11 lbs)	5 kg (11 lbs)	5 kg (11 lbs)
Oil	OIL 15	OIL 15	OIL 15	OIL 15

**⚠ CAUTION**

The release pressure of the pressure relief valves does not correspond to the system normal pressure but it represents only the use limits.

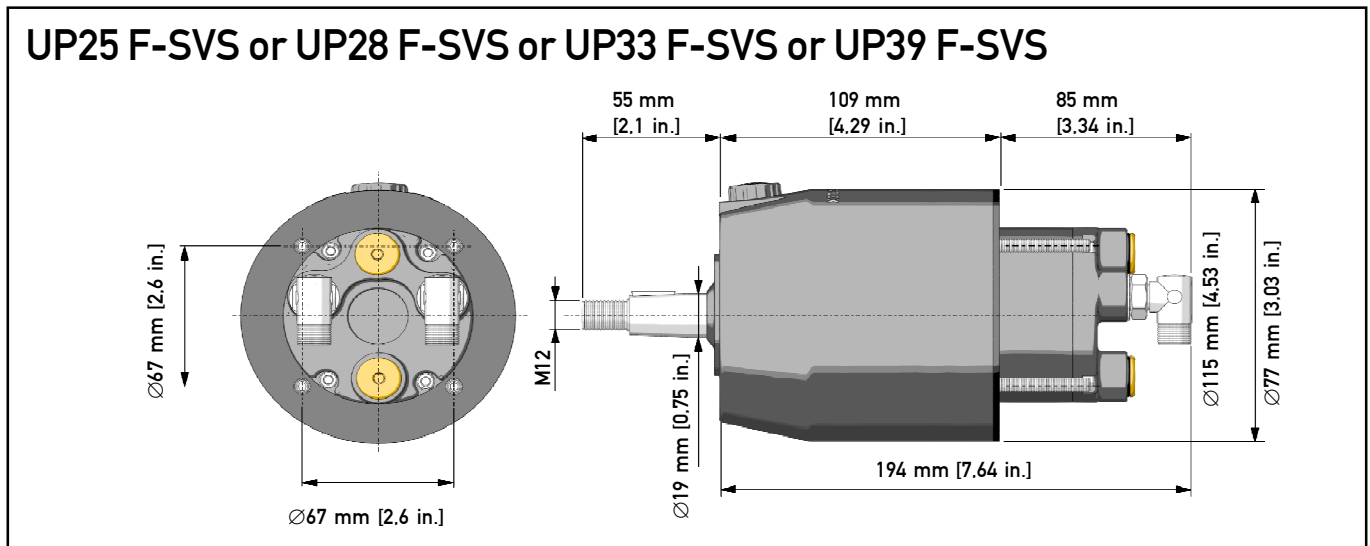

SPECIFICATIONS	PUMP UP25 T-SVS	PUMP UP28 T-SVS	PUMP UP33 T-SVS	PUMP UP39 T-SVS
Capacity	25 cc/rev. - 1,7 cu.in/rev.	28 cc/rev. - 1,7 cu.in/rev.	33 cc/rev. - 2,0 cu.in/rev.	39 cc/rev. - 2,0 cu.in/rev.
Pressure relief valve release pressure	105 bar (1500 psi)	105 bar (1500 psi)	105 bar (1500 psi)	105 bar (1500 psi)
No. of pistons	5	5	7	7
Max. steering wheel diameter	406 mm (16 in.)	406 mm (16 in.)	406 mm (16 in.)	406 mm (16 in.)
Max. steering wheel height	152 mm (6 in.)	152 mm (6 in.)	152 mm (6 in.)	152 mm (6 in.)
Weight	5 kg (11 lbs)	5 kg (11 lbs)	5 kg (11 lbs)	5 kg (11 lbs)
Oil	OIL 15	OIL 15	OIL 15	OIL 15

**⚠ CAUTION**

The relief valve pressure is not the one expected under normal conditions of the system: it is the pressure set under extreme working conditions.

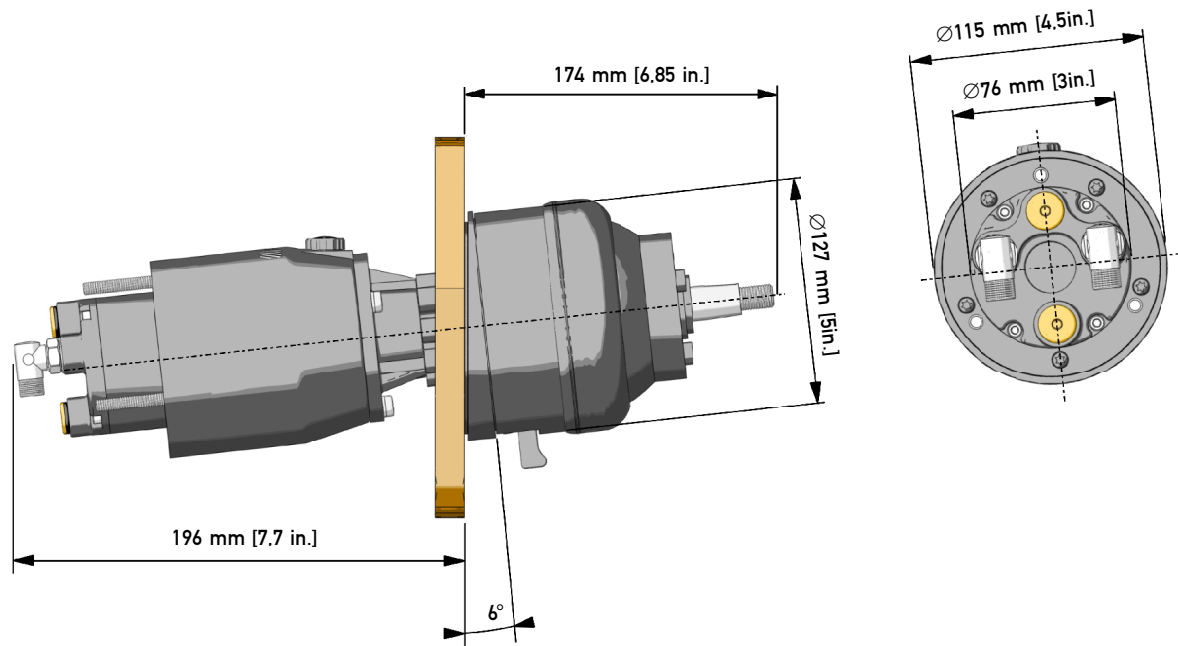

**UP25 T-SVS or UP28 T-SVS or UP33 T-SVS or UP39 T-SVS****⚠ CAUTION**

The pumps UP25 T-SVS, UP28 T-SVS, UP33 T-SVS e UP39 T-SVS can only be used with tilt **UFLEX X70** (supplied separately).



## 2 TRANSPORT

### 2.1 General warnings

The pump UP25 F-SVS, UP28 F-SVS, UP33 F-SVS, UP39 F-SVS, UP28 T-SVS, UP33 T-SVS and UP39 T-SVS weight with their packaging is 5kg (11 pounds) and so they can be handled manually.

**⚠ WARNING**

The staff in charge of handling must operate with protective gloves and safety shoes.

### 2.2 Packaging contents

Before using the equipment check that the product has not been damaged during transport. Also make sure that all the standard components are in the packaging (see list). In case of damage, notify the claim to the forwarder and inform the supplier.

**UP25 F-SVS o UP28 F-SVS o UP33 F-SVS o UP39 F-SVS**

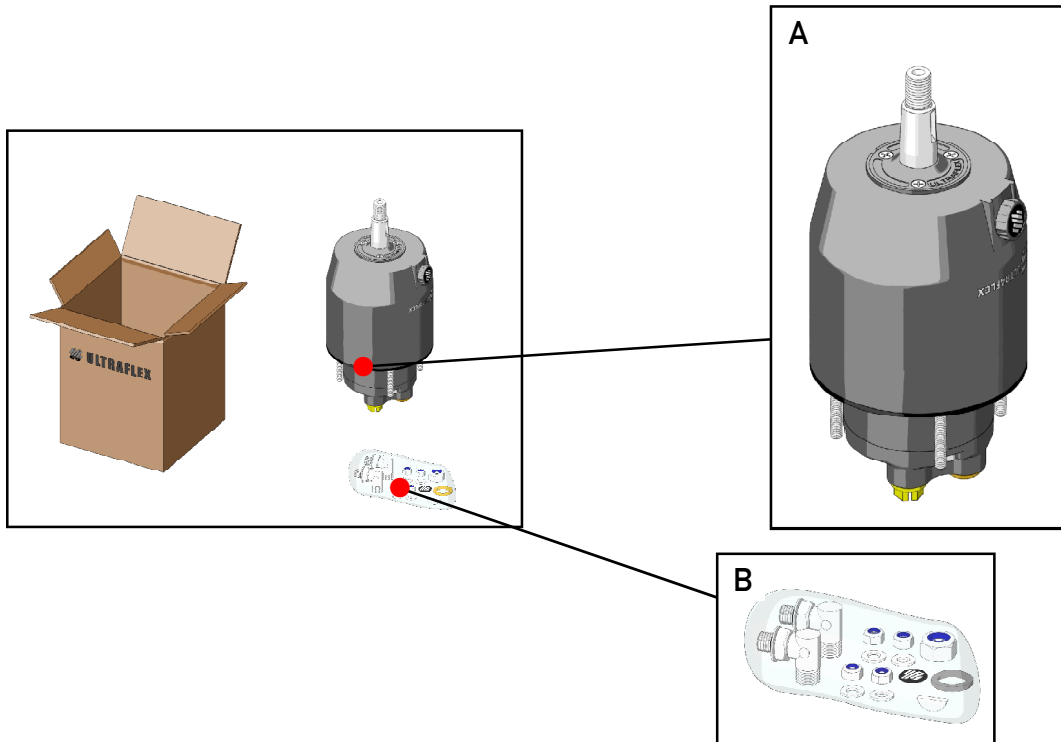

**THE STANDARD PACKAGING CONTAINS:**

- A ) No. 1 pump UP25 F-SVS or UP28 F-SVS or UP33 F-SVS or UP39 F-SVS.
- B ) No. 2 90° swinging unions to connect the hoses;
- No. 4 nuts for fixing the pump to the dashboard;
- No. 4 washers for fixing the pump to the dashboard;
- No. 1 nut for steering wheel tightening;
- No. 1 washer for steering wheel tightening;
- No. 1 key for steering wheel tightening;
- No. 1 label for plug.

**⚠ CAUTION**

The packaging must be disposed of according to the existing laws.



**UP25 T-SVS or UP28 T-SVS or UP33 T-SVS or UP39 T-SVS**

ENGLISH

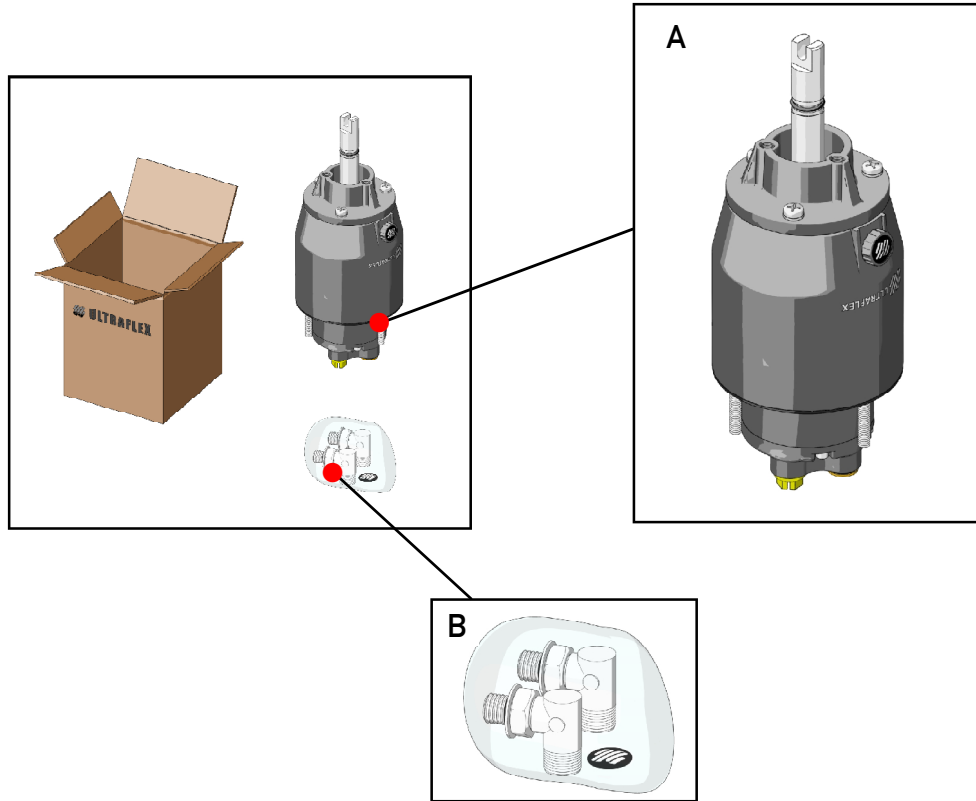

**THE STANDARD PACKAGING CONTAINS:**

- A ) No. 1 pump UP25 T-SVS or UP28 T-SVS or UP33 T-SVS or UP39 T-SVS.
- B ) No. 2 90° swinging unions to connect the Kit OB hoses (supplied separately);  
No. 1 label for plug.

**⚠ CAUTION**

The packaging must be disposed of according to the existing laws.



# 3 INSTALLATION

## 3.1 Necessary tools to install pumps UP25 F-SVS - UP28 F-SVS - UP33 F-SVS - UP39 F-SVS

ENGLISH



Loctite 542/545  
(only for additional station)



MOLYKOTE® 1000



Torque wrench

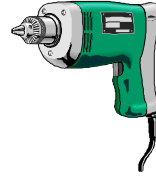

Drill



Open end wrench 10 mm



Open end wrench 19 mm



Open end wrench 11/16"

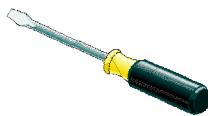

Screwdriver



7/16" open end wrench (only for additional station)



4 mm Allen wrench (only for additional station)

## 3.2 Pump UP25 F-SVS - UP28 F-SVS - UP33 F-SVS - UP39 F-SVS installation



**1** Select a suitable place for the steering station. Make sure that there is enough manoeuvring space for the steering wheel and for the steering pump and its pipes and fittings.

**⚠ WARNING**

In order to fix the pump properly, the maximum dashboard thickness must be 30 mm [1.18 in.]. Different thicknesses could compromise the driving safety.

Make sure that the breaking ring of the 4 self-locking nuts supplied is engaged by the dowel thread.

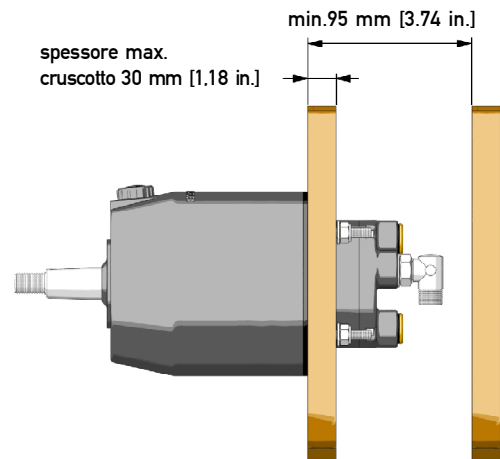

**2** Remove the plugs (1) from the pump (2) by using a screwdriver.

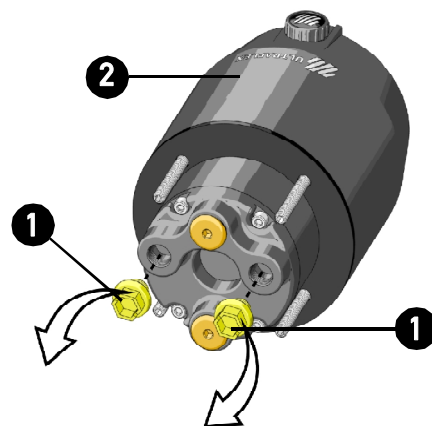

**3** Screw the nuts completely on the corresponding 90° unions (3). Fit and screw the unions manually as indicated in the picture until they are inserted completely. Turn them until they are positioned correctly with respect to the pipes by unscrewing them no more than one revolution, then tighten the nuts with a 11/16" Allen wrench with a torque of 17.6 Nm (13 lb ft) until the washer touches the nut.

**⚠ WARNING**

DO NOT USE teflon tape or adhesive tape.  
DO NOT PUT any thread sealant like Loctite 542 or similar products.

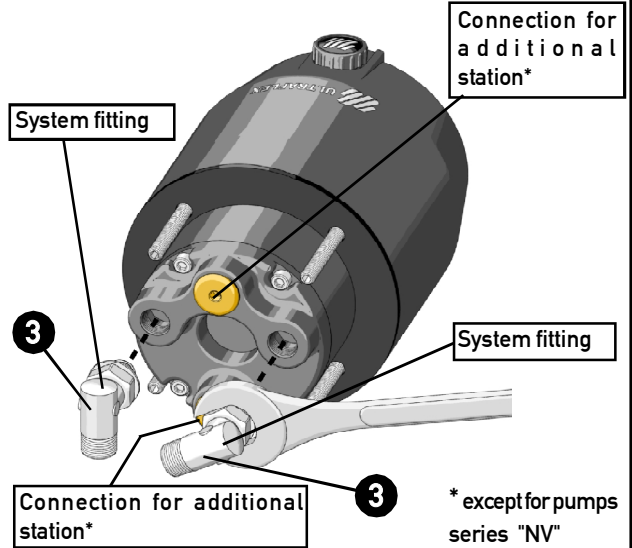

**ONLY IN CASE OF ADDITIONAL STATIONS**

**4 FITTING APPLICATION FOR ADDITIONAL STATIONS**

Position 3/8" straight unions (4) on the pumps as indicated in the picture. Put some fitting sealant type Loctite 542 or Loctite 545 on the thread. Fit and screw manually the fittings (4) until they are completely inserted; then tighten them with a 7/16" open end wrench with a torque of 17.6 Nm (156 lb ft).

**⚠ WARNING**

Do not use teflon tape or adhesive tape. Pay attention to the sealant positioning: if it is inserted into the system, it could block it and make it unusable.

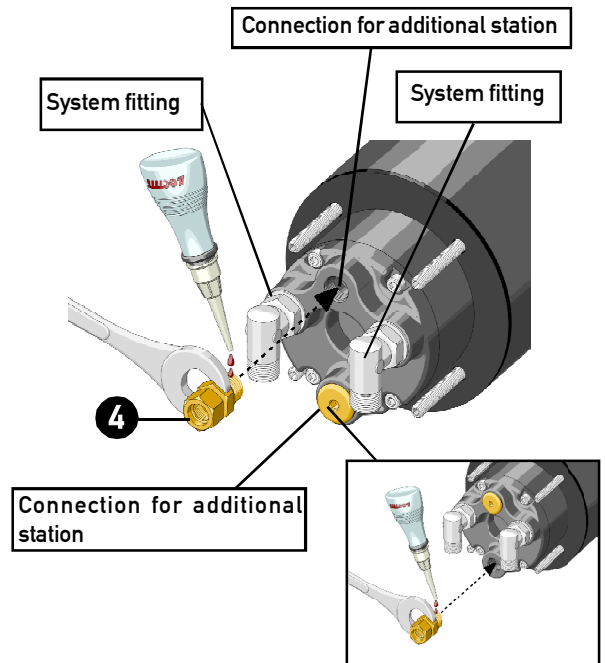

**5** By using the proper template supplied with this manual, make the holes for the dowels (5) required by the installation in the suitable position on the dashboard.

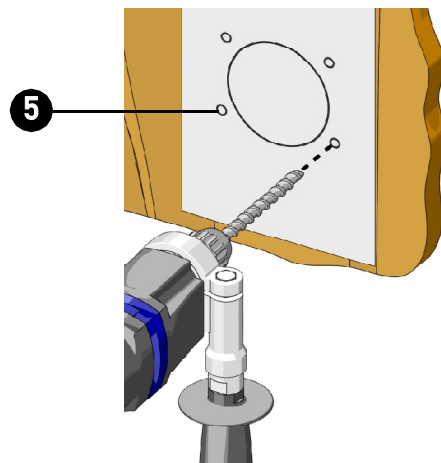

**6** Position the pump (2) on the dashboard front side (6) interposing the gasket (7) and fix it by inserting the 4 washers (8) and by tightening the 4 self-locking nuts (9) with a 10 mm wrench and a torque of 10 Nm (7.4 lb ft).

**⚠ CAUTION**

If the self-locking nuts are disassembled (9), they must be replaced. (Contact our assistance service, see page 6).

**⚠ WARNING**

Install the pump by positioning the filling hole (10) towards the top (see the picture) for the right pump operation and to allow filling and purging the system completely (see par. 3.7).

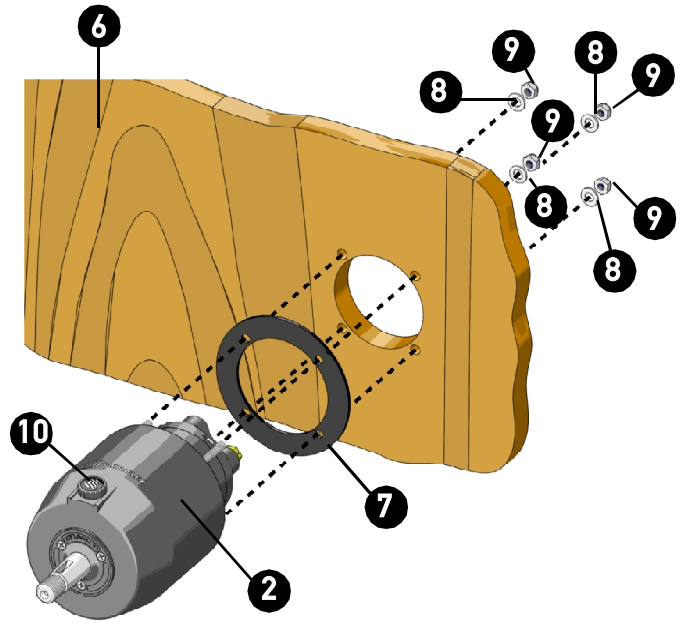

**7** Position the steering wheel supplied separately (11) on the pump shaft (12) by using the suitable key (13). Insert the washer (14) and tighten the self-locking nut (15) with a 19 mm open end wrench and with a torque of 40 Nm (29.5 lb ft); then grease the thread by using some anti-seize grease MOLYKOTE® 1000 or a similar one.

**⚠ CAUTION**

If the self-locking nut (15) is disassembled, it must be replaced. (Contact our assistance service, see page 6).

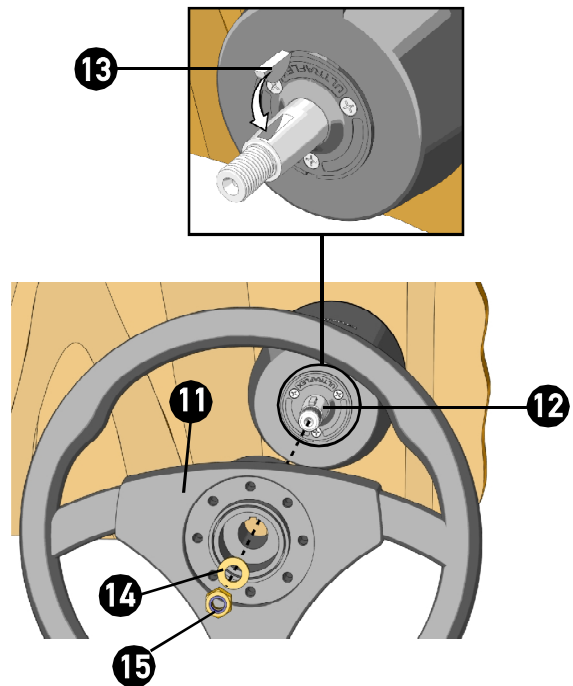



**3.3 Necessary tools to install pumps UP25 T-SVS - UP28 T-SVS - UP33 T-SVS - UP39 T-SVS**



Open end wrench  
11/16"

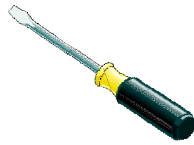

Screwdriver



Loctite 542/545 (only for  
additional station)



7/16" open end wrench  
(only for additional station)

\* The tools to assemble tilt X70 are listed in the manual enclosed to tilt X70.

**3.4 Pump UP25 T-SVS - UP28 T-SVS - UP33 T-SVS - UP39 T-SVS installation**



**⚠ CAUTION**

The tilt X70 mechanism is supplied separately.

- 1 Select a suitable place for the steering station. Make sure that there is enough manoeuvring space for the steering wheel and for the steering pump and its pipes and fittings.

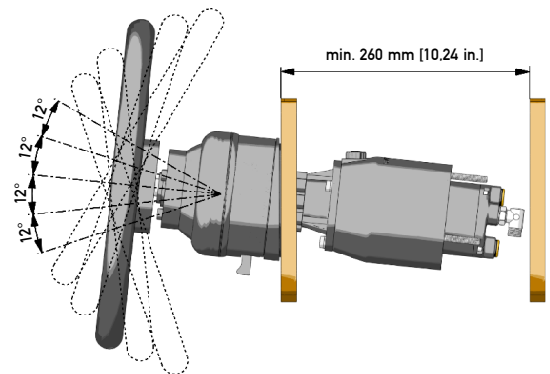

- 2 Remove the plugs (1) from the pump (2) by using a screwdriver.

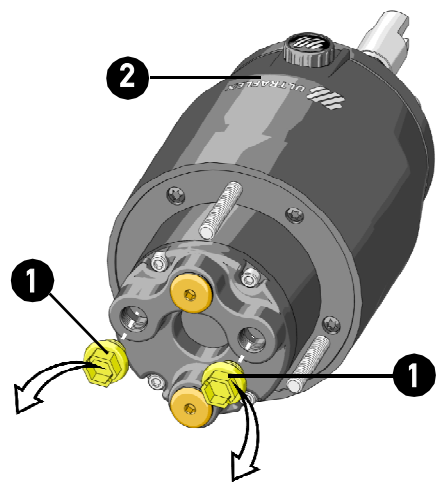

- 3 Fix the bracket (3) supplied with tilt X70 to the dashboard (4) by following the instructions enclosed to tilt X70.

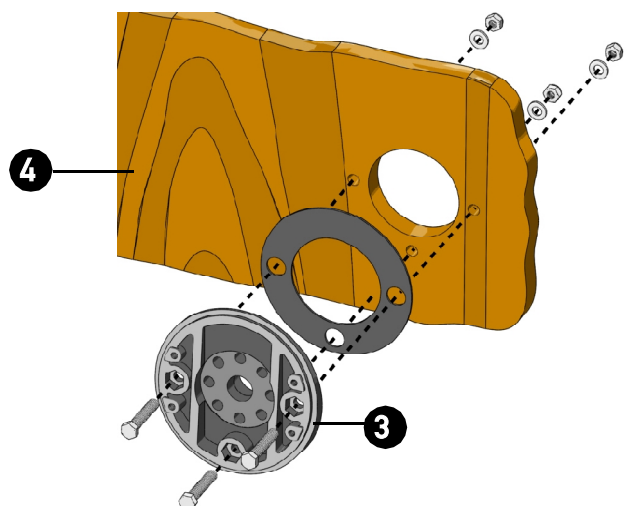

4 Screw the nuts completely on the corresponding 90° unions (3). Fit and screw the unions manually as indicated in the picture until they are inserted completely. Turn them until they are positioned correctly with respect to the pipes by unscrewing them no more than one revolution, then tighten the nuts with a 11/16" Allen wrench with a torque of 17,6 Nm (13 lb ft) until the washer touches the nut.

**⚠ WARNING**

DO NOT USE teflon tape or adhesive tape.  
DO NOT PUT any thread sealant like Loctite 542 or similar products.

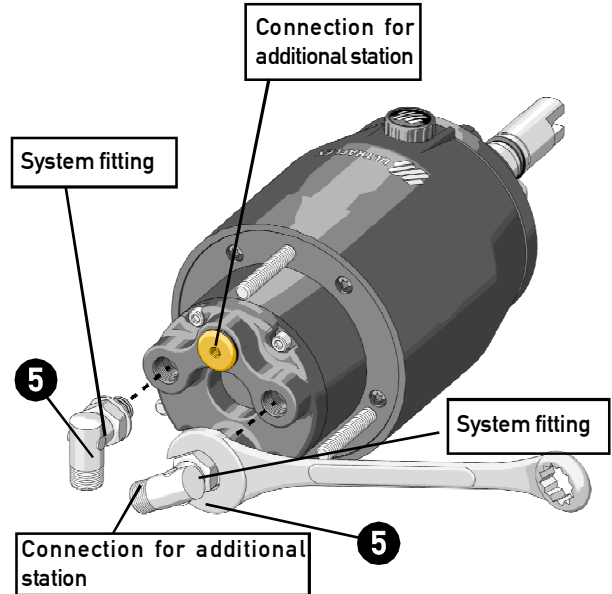

**ONLY IN CASE OF ADDITIONAL STATIONS**

**5 FITTING APPLICATION FOR ADDITIONAL STATIONS**

Position 3/8" straight unions (6) on the pumps as indicated in the picture. Put some fitting sealant type Loctite 542 or Loctite 545 on the thread. Fit and screw manually the fittings (6) until they are completely inserted; then tighten them with a 7/16" open end wrench with a torque of 17,6 Nm (156 lb ft).

**⚠ WARNING**

Do not use teflon tape or adhesive tape. Pay attention to the sealant positioning: if it is inserted into the system, it could block it and make it unusable.

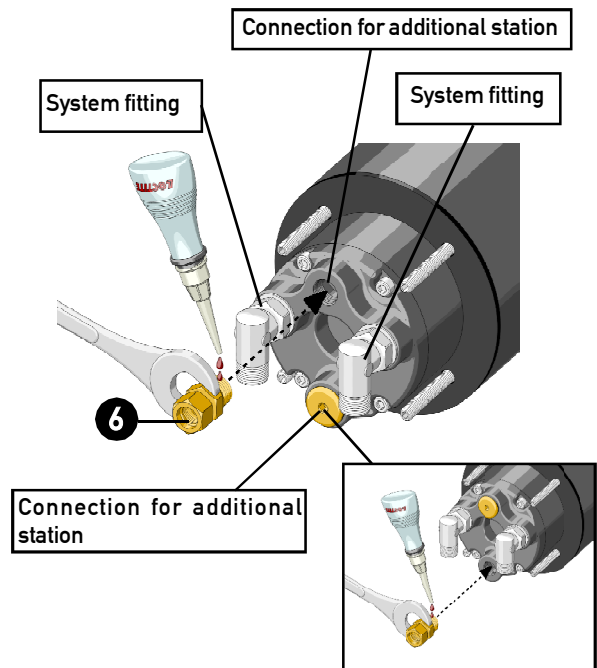

6 Fix the pump to the bracket (3) supplied with tilt X70 by using the 3 M8 screws (7) supplied with tilt X70 according to the instructions enclosed to tilt X70.

**⚠ WARNING**

Install the pump by positioning the filling hole (8) towards the top (see the picture) for the right pump operation and to allow filling and purging the system completely (see par. 3.7).

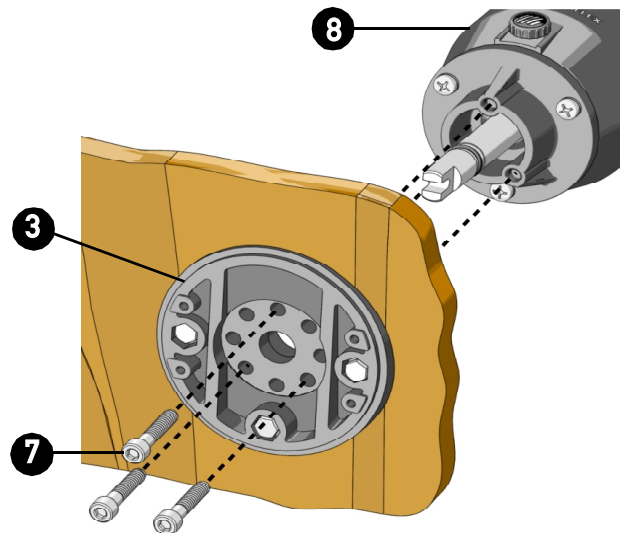

**7** Align and insert the tilt universal joint into the pump shaft by loosening about 1-1.5 turns the screws (9) on the universal joint itself always according to the procedure described in the installation manual supplied with tilt X70. Retighten the screws (8) and fix the tilt.

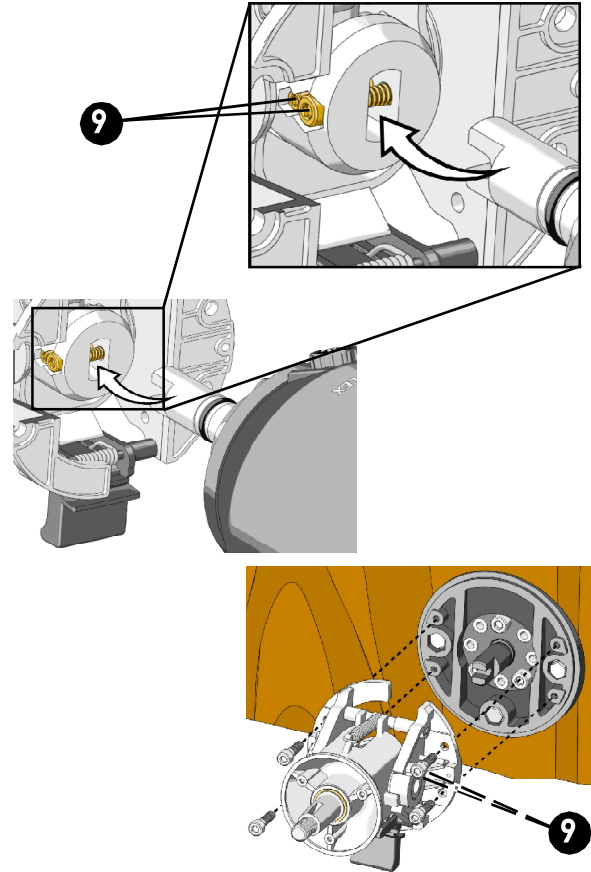

**NOTICE**

The kit **UFLEX** supplied separately (see the corresponding instructions) can be used on pumps UP28 F-SVS, UP33 F-SVS, UP39 F-SVS, UP28 T-SVS, UP33 T-SVS and UP39 T-SVS to simplify the hydraulic system filling and purging.



### 3.5 Types of installation



The pumps UP25 F-SVS, UP28 F-SVS, UP33 F-SVS, UP39 F-SVS, UP28 T-SVS, UP33 T-SVS and UP39 T-SVS can be installed in a single or dual station and they can be used only with SVS hydraulic cylinders and hoses (outboard cylinder UC128-SVS and Kit OB-SVS).

**⚠ CAUTION**

Connect hoses as shown in the installation and maintenance manual of the hydraulic cylinder for outboard engines UC128-SVS.

ENGLISH

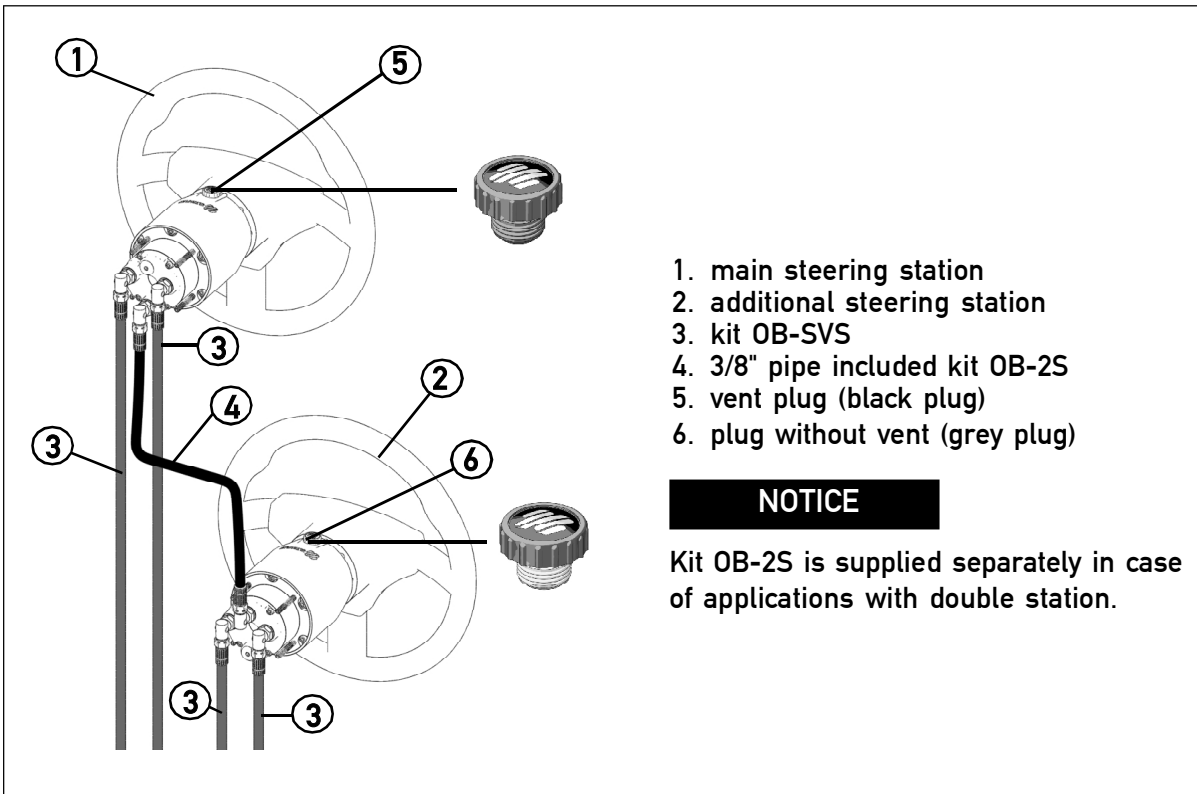

### 3.6 Hose connection to the system



- 1 Connect the hydraulic hoses **UFLEX** kit OB-SVS (supplied separately) joining the pump and the cylinder by following the instructions given in the installation manual of the kit OB-SVS.
- 2 If one or more additional steering stations are installed, use the kit OB-2S by following the suitable instructions.

**MAIN STEERING STATION**

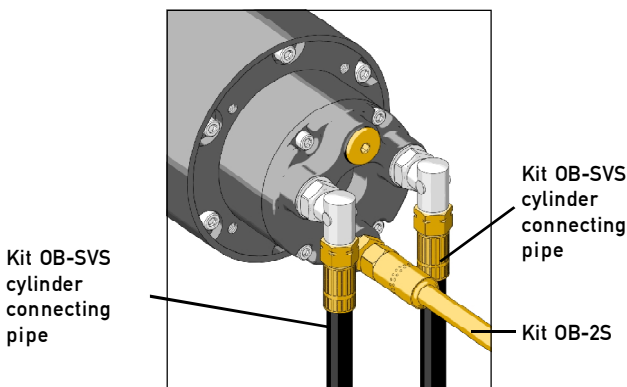

**ADDITIONAL STEERING STATION**

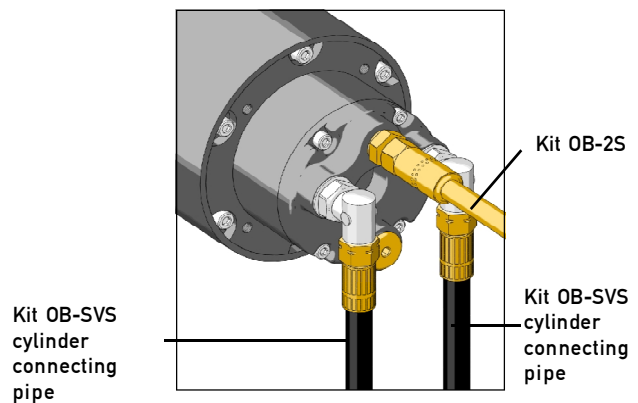

**⚠ WARNING**

Keep the pipes far from heat sources and from chemical substances. Protect the pipes that must pass through bulkheads by using suitable thru hulls. The bends must be perfectly smooth; any bent pipe or dent would prevent the hydraulic oil passage.

**⚠ WARNING**

Keep clean. Make sure that working areas are free from dust and dirt. The protective plugs of threaded holes must be removed only before the connection of fittings and pipes. Make sure that pipes are perfectly clean and free from swarf. If copper or steel pipes are used, cleaning is mandatory. If the installer uses pipes that are different from Kit OB-SVS, he must take full responsibility for it.

**⚠ WARNING**

At the end of the installation make sure that the pipes do not interfere with the engine and with fixed or mobile parts of the boat or of the steering system itself.

**⚠ WARNING**

The minimum bending radius of the pipes is 250 mm. Any excessive pipe bending could break them by compromising the good operation of the system. If necessary, replace the damaged pipe.

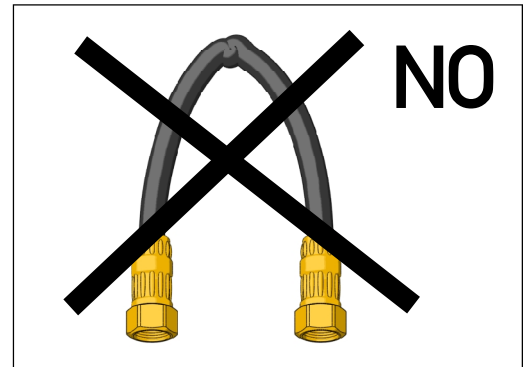
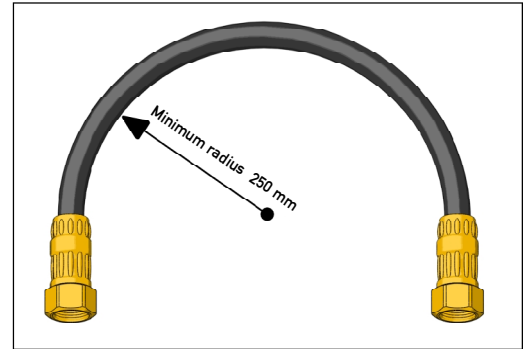

**3.7 Filling and purging**

After the first installation and after maintenance operations it is necessary to fill the system with hydraulic oil. This operation must avoid the air in the system, to ensure the good system operation. The hydraulic system must be filled from the highest point of the system, which means from the upper steering station.

**⚠ CAUTION**

To avoid air bubbles in the oil, it is necessary to fill the tank slowly.

**⚠ WARNING**

The filling and bleeding operations must be carried out at least by two operators.

**⚠ DANGER**

Use **UFLEX** oil or other compatible oils.

Hydraulic oil OIL15 has been specifically formulated for **UFLEX** to ensure high quality performance level of **UFLEX** products throughout time.

The special mix of anti-wear and stabilizing components of OIL15 allow ensuring great results as far as the product duration and performances are concerned in several environmental conditions. **UFLEX** is not to be held responsible for any damages or performance deterioration if oils different from OIL15 are used.

**⚠ DANGER**

Do NOT use ATF Dexron II transmission oils or brake oils which could cause the steering system seizing.

Oils which are compatible with OIL15 **UFLEX** are:

- Shell Tellus T15 and Shell Tellus T22
- Mobil DTE 11M



**NOTICE**

**UFLEX** will not be able to ensure the compatibility of the above mentioned oils with OIL15 if the oil manufacturers vary their formulation. Under no circumstances **UFLEX** is to be held responsible for any damages or performance deterioration.

In the days after the filling, check the oil level; if necessary top off the system. At the beginning the oil level can lower, as small amounts of air can be released in a homogeneous way. According to the types of installation, it is necessary to carry out the different bleeding procedures, as it follows.

**3.7.1 Positioning of the oil bottle**

To carry out this operation, it is necessary to use the oil filling kit (1 needle, 1 transparent pipe, 1 pipe connection and 1 spout for the oil bottle). This kit is NOT supplied.

- Remove the pump cap and insert the fittings.
- Attach the spout to a new bottle of hydraulic oil and connect the hose to the fittings and the bottle spout.
- Turn the bottle upside down and pierce it with the pin, as shown in the picture, to ease the oil passage towards the pump.  
Fill the pump until no air bubbles are visible in the hose.

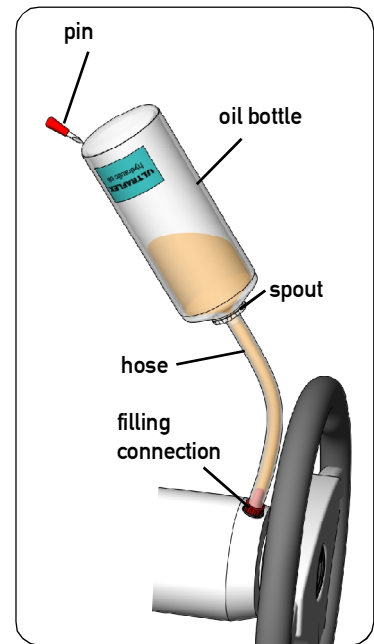

**⚠ WARNING**

While replacing the oil bottle, during the filling process, close all the bleed valves on the "T" fittings of the cylinder/s. To bleed the system, check that oil is always present in the filling hose. If some air is in the system during the bleeding process, the whole bleeding process must be started again.

**⚠ WARNING**

Replace the bottle before it empties and use recovered oil only after 24 hours.

**3.7.2 Purging procedure**

**NOTICE**

Carry out the purging procedure as indicated in the installation and maintenance manual of the cylinder used. Then check that the oil level is suitable by turning 1/2 turn the steering wheel and by making the oil come out of the bleed valve. Close the valve and check the system.

**3.8 General recommendation**

**⚠ WARNING**

It is very important to check the absence of air in the system before using the boat! We recommend trying to manually move the engine/s or the helm/s towards port and starboard, making sure that there is no movement of the cylinder body on the main cylinder shaft.

If the cylinder body moves too much, there is still air in the system. The air presence in the system can cause bad responses to the controls and so it can cause damage, injuries or death.

**⚠ WARNING**

Check the system response by moving the pump.

**⚠ DANGER**

After 24 hours repeat the purging and make sure there are no leaks.



# 4 SAFETY WARNINGS

This section shows the safety rules which must be followed for the correct equipment operation. We recommend reading carefully this section and also the other manuals supplied with the steering system components.

## 4.1 Safety warnings during use and installation

RESPECT STRICTLY the following safety rules.

**UFLEX** declines all responsibility in case the user does not follow these rules and it is not responsible for negligence during the use of the system.

### DANGER

- **DO NOT PUT HANDS BETWEEN THE MOVING PARTS.**
- Do not disable the safety devices.
- Do not modify or add devices to the system, without **UFLEX** written authorisation or technical intervention which will prove the modification.
- Do not use the equipment for a purpose different from the one it has been designed for, which is specified in the installation and maintenance manual.
- Do not let non-specialized staff perform the installation.
- Do not disassemble the hydraulic connections before bleeding the oil in the system completely. The hoses can contain high pressure oil.
- In case of installation with double station DO NOT use both stations. As a matter of fact the two stations are always enabled on the steering compartment. The effect of the rudden rotation on both stations will double causing an undesired manoeuvre.

### WARNING

- Do not put the feet on the cylinder.
- Check the system after the installation and the purging but before operating the vessel. Turn the steering wheel until the cylinder/s reaches/reach the end stroke. Turn the steering wheel to the opposite direction. Repeat on each installed helm to verify the correct installation and the system operation.
- Carefully use sealing fluid (such as Loctite). If it reaches the hydraulic system, it may cause damage and mechanical failure.
- Do not use teflon tape or adhesive tape to seal the fittings, as this material may be injected, by causing the system fail.
- During the system installation, prevent foreign matters from entering the system. Even a little object may cause lasting damage that are not detected immediately.
- Avoid too narrow bend radius of hoses.
- Avoid the hose contact with edges or sharp corners.
- Avoid the hose contact with heat sources.

## 4.2 Clothing

### WARNING

During installation, inspection or maintenance, IT IS STRICTLY FORBIDDEN to wear necklaces, bracelets or clothes which could get caught in the moving parts.



# 5 MAINTENANCE

## 5.1 Ordinary maintenance

**⚠ WARNING**

Poor installation and maintenance may result in loss of steering and cause property damage and/or personal injury. Maintenance requirements change according to climate, frequency and the use. Inspections are necessary at least every year and must be carried out by specialized marine mechanics. Check the cylinder fittings and the seals and the helm gaskets to prevent leaks. Replace them if necessary.

To keep a suitable oil level in the tank, fill and bleed the system as described in this manual in paragraph 3.7 and in the bleeding procedure of **UFLEX** cylinders. Check the hose and the entire system wear, the nut and bolt tightening every six months and make sure that they are not damaged. Clean the system using water and non-abrasive soap.

**⚠ DANGER**

Use only compatible hydraulic oils, indicated in the paragraph "technical features" and "filling and purging". Do not use brake oils or automatic transmission fluid (ATF) in any case.

**⚠ CAUTION**

If the self-locking nuts are disassembled, they must be replaced. (Contact our assistance service, see page 6).

## 5.2 Steering wheel disassembly

To remove the steering wheel from the pump shaft, use a suitable extractor.

**⚠ WARNING**

Do not use a hammer or other tools that could seriously damage the pump.

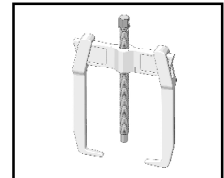

## 5.3 Troubleshooting

**⚠ WARNING**

Whenever the following checks need the removal and/or disassembly of the steering system components, such work must be carried by specialized staff. **UFLEX** offers general information only and is not responsible for any consequences resulting from incorrect disassembly.

PROBLEM	CAUSE	SOLUTION
During the filling, the steering system becomes completely jammed.	<ul style="list-style-type: none"> <li>Blockage in the hoses between steering system and cylinder.</li> </ul>	<ul style="list-style-type: none"> <li>Replace hoses.</li> </ul> <p><b>⚠ DANGER</b> The damaged hose must be replaced, otherwise it may cause loss of steering and severe personal injury or property damage.</p>
The system is very difficult to fill. Air keeps bubbling at the top of the steering system tank even after filling the system completely.	<ul style="list-style-type: none"> <li>Air in the system.</li> </ul>	<ul style="list-style-type: none"> <li>Repeat the filling and the bleeding procedure of the system.</li> <li>Install horizontally the hoses and in any case with a maximum inclination of 3cm each meter.</li> </ul>
	<ul style="list-style-type: none"> <li>Leaks from the cylinder bleeder.</li> </ul>	<ul style="list-style-type: none"> <li>Tighten the bleeder on the cylinder.</li> </ul>
	<ul style="list-style-type: none"> <li>Coiled hose.</li> </ul>	<ul style="list-style-type: none"> <li>Uncoil and straighten the hose.</li> </ul>
	<ul style="list-style-type: none"> <li>Helm has been mounted upside down.</li> </ul>	<ul style="list-style-type: none"> <li>Mount the helm with the filling hole in up position.</li> </ul>





The steering system is stiff and hard to turn, even when the boat is not moving.	<ul style="list-style-type: none"> <li>Restrictions in hoses or fittings.</li> </ul>	<ul style="list-style-type: none"> <li>Look for and remove the restriction.</li> </ul>
	<ul style="list-style-type: none"> <li>Air in oil.</li> </ul>	<ul style="list-style-type: none"> <li>Repeat the filling and the bleeding procedure of the system.</li> </ul>
The steering system is stiff and hard to turn, even when the boat is not moving.	<ul style="list-style-type: none"> <li>Wrong oil has been used.</li> </ul>	<ul style="list-style-type: none"> <li>Drain the filling and bleeding system.</li> </ul> <p><b>⚠ WARNING</b>                      UFLEX is not responsible for damage caused by fluids that are not recommended in this manual and so the warranty is cancelled.</p>
	<ul style="list-style-type: none"> <li>Dirt in the valve.</li> </ul>	<p><b>⚠ WARNING</b>                      Do not use the boat and contact a specialized technician for the valve cleaning.</p>
The steering system is easy to turn at the dock but becomes hard to turn when the boat is in motion.	<ul style="list-style-type: none"> <li>The steering wheel is too small.</li> </ul>	<ul style="list-style-type: none"> <li>Replace the steering wheel with a bigger one.</li> </ul> <p><b>⚠ WARNING</b></p>
	<ul style="list-style-type: none"> <li>Incorrect setting of the torque tab.</li> </ul>	<ul style="list-style-type: none"> <li>Only within the maximum dimensions allowed by the helm.</li> <li>Adjust the torque tab.</li> </ul>
	<ul style="list-style-type: none"> <li>Air in oil.</li> </ul>	<ul style="list-style-type: none"> <li>Check the oil level and repeat the bleeding procedure as explained in this manual.</li> </ul>
When the steering wheel is turned, the rod (movable rod cylinders) or the body (fixed cylinder rod) of the cylinder do not move.	<ul style="list-style-type: none"> <li>Air in the system.</li> </ul>	<ul style="list-style-type: none"> <li>Repeat the filling and bleeding procedure of the system.</li> </ul>
	<ul style="list-style-type: none"> <li>Oil leak.</li> </ul>	<ul style="list-style-type: none"> <li>Look for the leak and contact specialized staff.</li> </ul>
	<ul style="list-style-type: none"> <li>Helm mounted upside down.</li> </ul>	<ul style="list-style-type: none"> <li>Mount the helm with the filling hole in up position.</li> </ul>
Leaks from steering system fittings.	<ul style="list-style-type: none"> <li>Bad tightening or low torque of the fittings.</li> </ul>	<ul style="list-style-type: none"> <li>Tighten the fittings with a maximum torque of 20Nm (15 in.lbs).</li> </ul>
	<ul style="list-style-type: none"> <li>Lack of fitting sealant.</li> </ul> <p><b>⚠ WARNING</b>                      Never use teflon tape or adhesive tape on any fitting.</p>	<ul style="list-style-type: none"> <li>Drain and disassemble the steering system. Remove the fittings and remove the oil from threads. Put the sealant on the fittings and tighten them. install the helm.</li> </ul> <p><b>⚠ WARNING</b>                      After this operation it is necessary to carry out another bleeding.</p>
Leaks from the tank plug.	<ul style="list-style-type: none"> <li>Bad tightening of the plug.</li> <li>The vent plug on the additional helm is in the lower position.</li> </ul>	<ul style="list-style-type: none"> <li>Tighten the plug.</li> <li>Replace the vent plug with the plug for the additional helm kit.</li> </ul>
	<ul style="list-style-type: none"> <li>Worn and damaged seal.</li> </ul>	<ul style="list-style-type: none"> <li>Replace the plug.</li> </ul>
	<ul style="list-style-type: none"> <li>Too high oil level.</li> </ul>	<ul style="list-style-type: none"> <li>Follow the procedure to maintain the suitable oil level, which is described in the pump manual.</li> </ul>



# 6 DISMANTLING

## 6.1 Dismantling

ENGLISH

When for any reason, the steering system is put out of service, it is necessary to follow some rules in order to respect the environment.

Sheaths, pipelines, plastic or non-metallic components must be disassembled and disposed of separately.

*The steering system **CONTAINS POLLUTING OILS** which must be disposed of according to the rules in force in the country.*

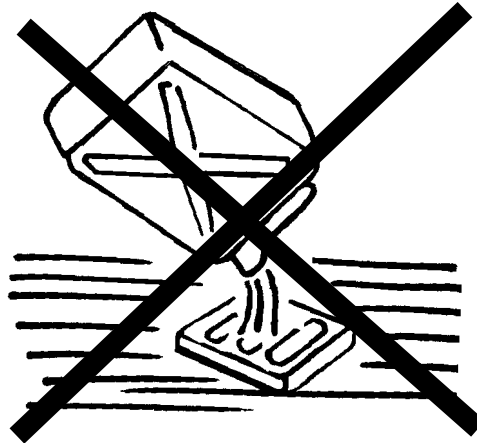



**UFLEX USA**

Sarasota, FL 34243 - 6442 Parkland Drive

